

# POCKET DOOR PRO HENDERSON

120kg Wood Interior

Professional sliding door solution that works with cavity walls for doors weighing up to 120kg

## Overview

Pocket Door Pro is a professional hardware solution that allows doors to effortlessly slide into a cavity wall. Designed with a high quality aluminium cavity frame, the system is extremely robust - making it ideal for new builds and areas of heavy use such as educational buildings, hospitals, hotels & office blocks. The cavity frame is provided with push together parts for easy and rapid installation. Available in seven different kit sizes and for a finished wall thickness of 120mm or 125mm - the system is extremely versatile. Pocket Door Pro is also available with an integrated soft close which catches the door for its final moments of travel - preventing slamming. For biparting kits, two kits can be purchased. For non soft closing biparting doors, you will also need to purchase two HH4A/N track stops (see accessories).

## Features and Benefits

- Robust aluminium cavity frame designed for easy and rapid installation
- Seven different kit sizes (covering doors up to 2315mm x 930mm)
- Available for 120mm or 125mm finished wall thickness
- Kit can be used with or without an architrave
- For bi-parting doors, two kits can be used
- Also available in fire rated and automated variants
- Liner kit available as an optional extra for a professional finish



## Product and Door Specification

Kit Order Code		Max. Door Width	Max. Door Height	Door Thickness Range	Max. Door Weight
Standard	With Soft Close				
PDKPRO1/**	-	610mm	1981mm	35 - 45mm**	120kg*
PDKPRO2/**	PROSOFT2/**	686mm	1981mm	35 - 45mm**	120kg*
PDKPRO3/**	PROSOFT3/**	762mm	1981mm	35 - 45mm**	120kg*
PDKPRO4/**	PROSOFT4/**	838mm	1981mm	35 - 45mm**	120kg*
PDKPRO6/**	PROSOFT6/**	826mm	2040mm	35 - 45mm**	120kg*
PDKPRO7/**	PROSOFT7/**	726mm	2040mm	35 - 45mm**	120kg*
PDKPRO10/**	PROSOFT10/**	930mm	2315mm	35 - 45mm**	120kg*

\*\*\*For full short code please replace with required finished wall thickness - 120 or 125 (mm)

\*Maximum door weight when specifying as a soft close kit is 80kg

\*\* Door thickness when specifying with a FD60 fire rated liner kit is 54mm

## Kit Contents

Aluminium Track (x 1)
Aluminium Upright (x4)
Hangers (x2)
Floor Guide (x1)
Fixing Plate (x4)
Header Fixing Bracket (x8)
Door Stop (x1)
Noggin c/w Fixing Block (x2) (x4 for PDKPRO10)
Floor Bracket (x2) (x4 for PDKPRO10)
Screws
Tie Back c/w Fixing Block (x4) (PDKPRO10 only)

## Accessories

Liner Kit	Full timber liner kit for a professional finish	LK/**	
Self Close Kit (Should be specified with PDKPRO Soft)	Doors close themselves after opening, complete with liner kit	SCLK/**	
Flush Pull	Oval, in satin or black	144B or 144S	
Flush Pull Set	Round, in satin, black, chrome or polished brass	385/S, 385/B, 385/C or 385PB	
Flush Pull Set with Door Edge Pull	Round, in satin, black or chrome. Ideal for use with soft close	385EDGE/S, 385EDGE/B or 385EDGE/C	
Indicator Lock Set	Satin or chrome	571/S or 571/C (For doors 40 - 45mm thick)	
Lock Set	Satin or chrome	390/S or 390/C (For doors 35 - 52mm thick)	

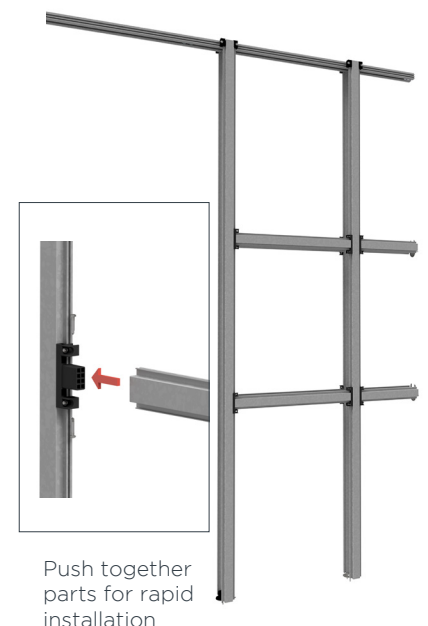

\*\*\*For full short code please replace with required finished wall thickness - 120 or 125 (mm)

## Watch the Installation Video

Visit [www.pchenderson.com/pocket-door-pro-installation](http://www.pchenderson.com/pocket-door-pro-installation) or scan the QR code using your phone

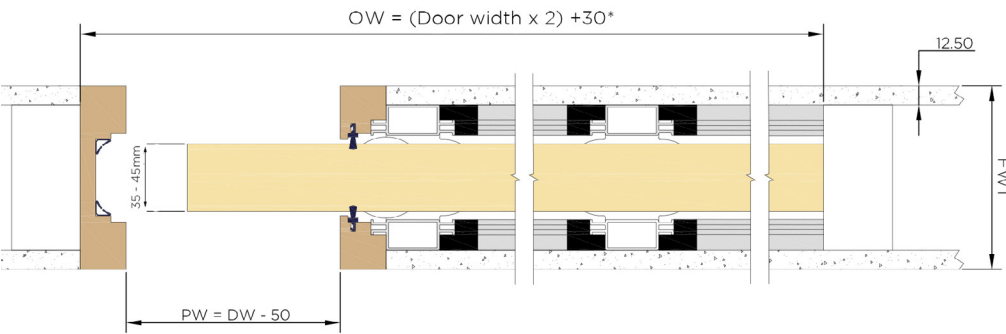
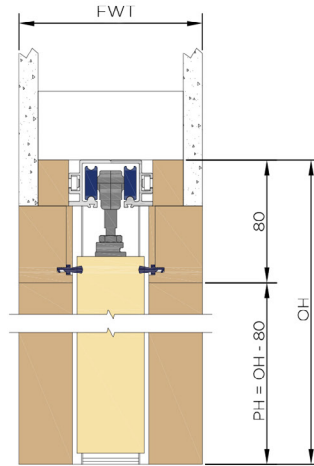
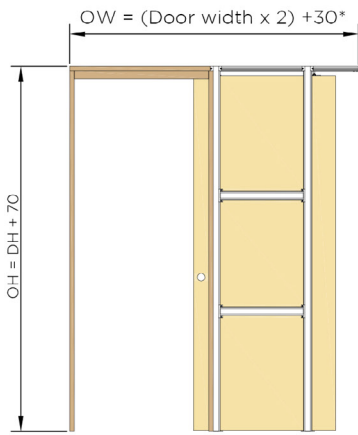
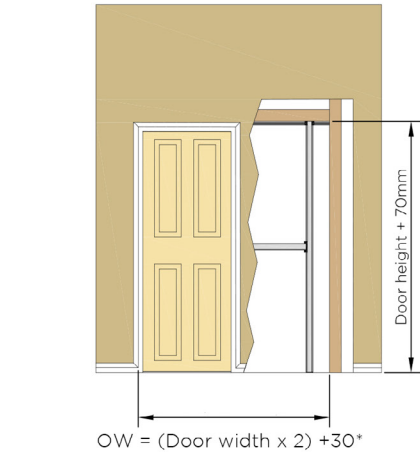

## Finished Wall Thickness Calculation

120mm Finished Wall Thickness

95mm cavity + 12.5mm plasterboard either side = 120mm finished wall thickness

125mm Finished Wall Thickness

100mm cavity + 12.5mm plasterboard either side = 125mm finished wall thickness

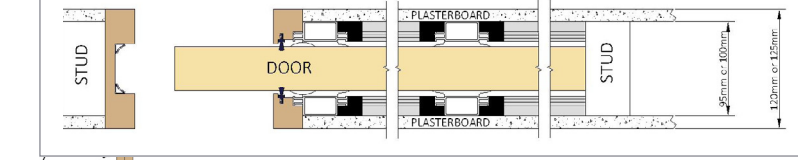

Floor guide & bracket

### For Biparting Doors

$$PW = (2 \times DW) - 50$$

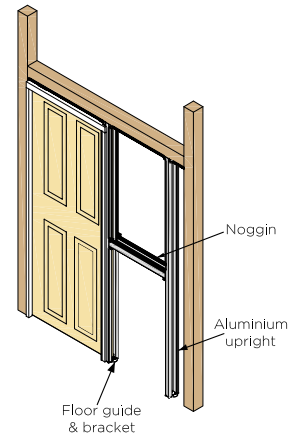

## Key

OW	Overall width
OH	Overall height
DH	Door height
DW	Door width
PH	Opening height
PW	Opening width
FWT	Finished wall thickness

\* If using a self close system, this dimension changes to 62mm.

## Opening Size Guide

Kit Short Code	Max. Passage Width (W x H)	Overall Dimensions (W x H)	Cavity Thickness	Finished Wall Thickness (WT)
PDKPRO1/**	560mm x 1971mm	1250mm x 2051mm	95mm or 100mm	120mm or 125mm
PDKPRO2/**	636mm x 1971mm	1402mm x 2051mm	95mm or 100mm	120mm or 125mm
PDKPRO3/**	712mm x 1971mm	1554mm x 2051mm	95mm or 100mm	120mm or 125mm
PDKPRO4/**	788mm x 1971mm	1706mm x 2051mm	95mm or 100mm	120mm or 125mm
PDKPRO6/**	776mm x 2030mm	1682mm x 2110mm	95mm or 100mm	120mm or 125mm
PDKPRO7/**	676mm x 2030mm	1482mm x 2110mm	95mm or 100mm	120mm or 125mm
PDKPRO10/**	880mm x 2305mm	1890mm x 2385mm	95mm or 100mm	120mm or 125mm

\*\*For full short code please replace with required finished wall thickness - 120 or 125 (mm)

For further information, please contact us on:

### UK Sales

T: +44 (0) 191 377 7345

E: [sales@pchenderson.com](mailto:sales@pchenderson.com)

W: [www.pchenderson.com](http://www.pchenderson.com)

### Export Sales

T: +44 (0) 191 377 7346

E: [international@pchenderson.com](mailto:international@pchenderson.com)

W: [export.pchenderson.com](http://export.pchenderson.com)